



Alliance Lingo

ALLIANCE LINGO

Elevator lingo is confusing. Is it a right hand door or a left hand door? Does the cab need to be gurney or ADA compliant? We understand not all of us grew up in the trade, and have put together the following to help take the guesswork out of some common elevator terminology. So go ahead, talk like a pro, we've got you covered (or just reach out to AES and we'll help you through it).

2SSO (LEFT HAND)

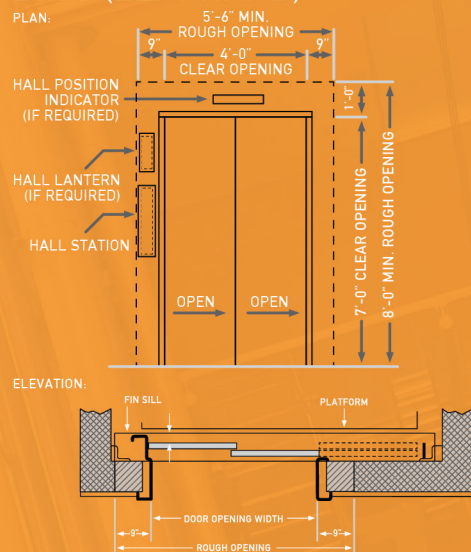

SSSO (LEFT HAND)

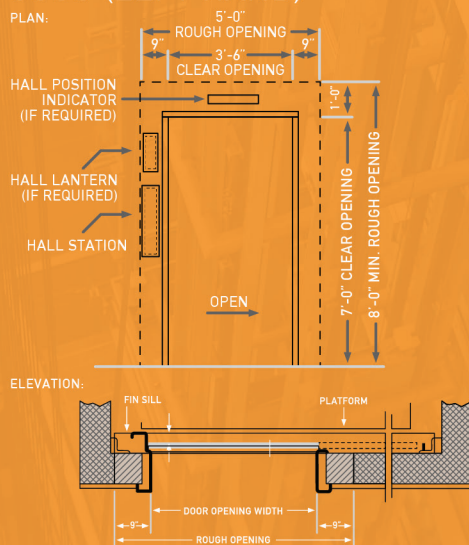

SSCO

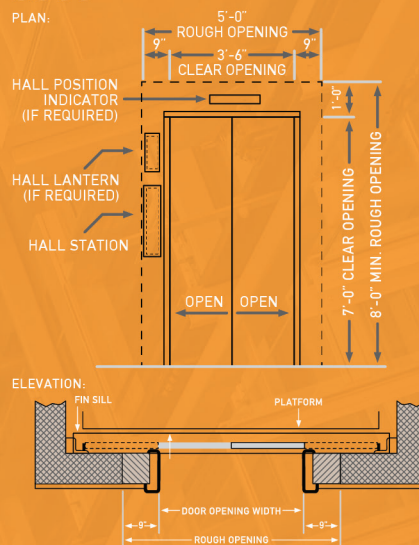

MAXIMUM* INSIDE NET PLATFORM AREAS FOR THE VARIOUS RATED LOADS

Rated Load (lb)	Inside Net Platform Area (ft ²)
500	7.0
600	8.3
700	9.6
1,000	13.25
1,200	15.6
1,500	18.9
1,800	22.1
2,000	24.2
2,500	29.1
3,000	33.7
3,500	38
4,000	42.2
4,500	46.2
5,000	50.0
6,000	57.7
7,000	65.3
8,000	72.9
9,000	80.5
10,000	88.0
12,000	103.0
15,000	125.1
18,000	146.9
20,000	161.2
25,000	196.5
30,000	231.0

GURNEY DIAGRAMS

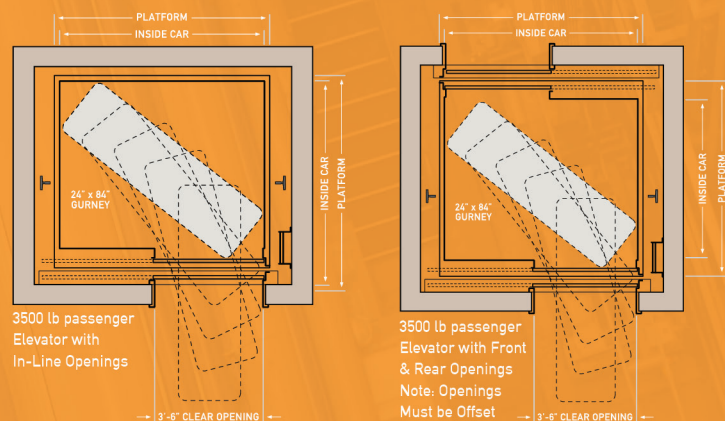

Note: If SSCO doors, car will not fit 24x84 gurney

SILL SUPPORT OPTIONS

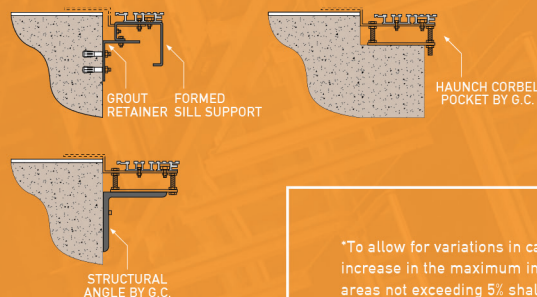

*To allow for variations in cab designs, and increase in the maximum inside net platform areas not exceeding 5% shall be permitted for the various rated loads.

GENERAL NOTE:
1 lb = 0.454 kg
1 ft² = 9.29 E-2m²

TOP OF CAR CLEARANCES

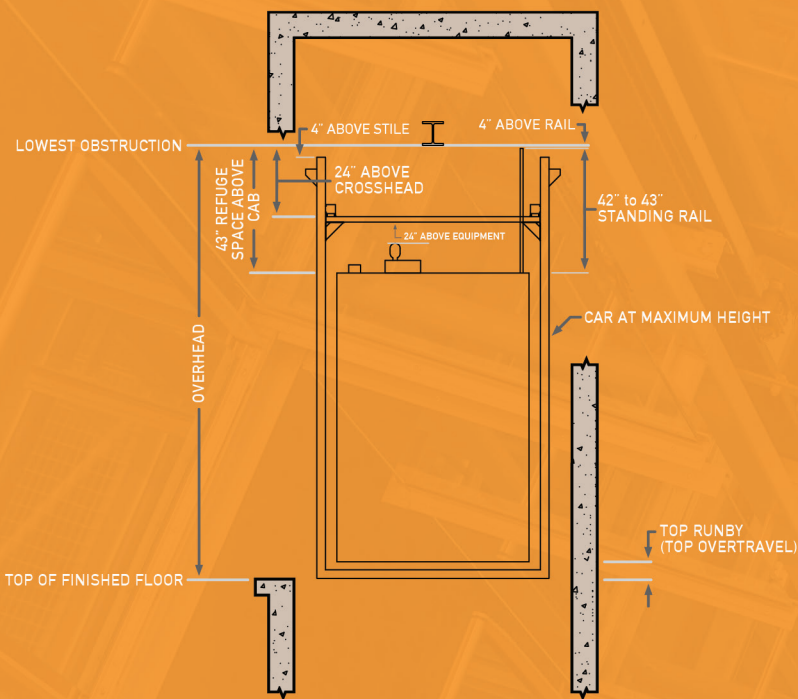

MACHINE ROOM

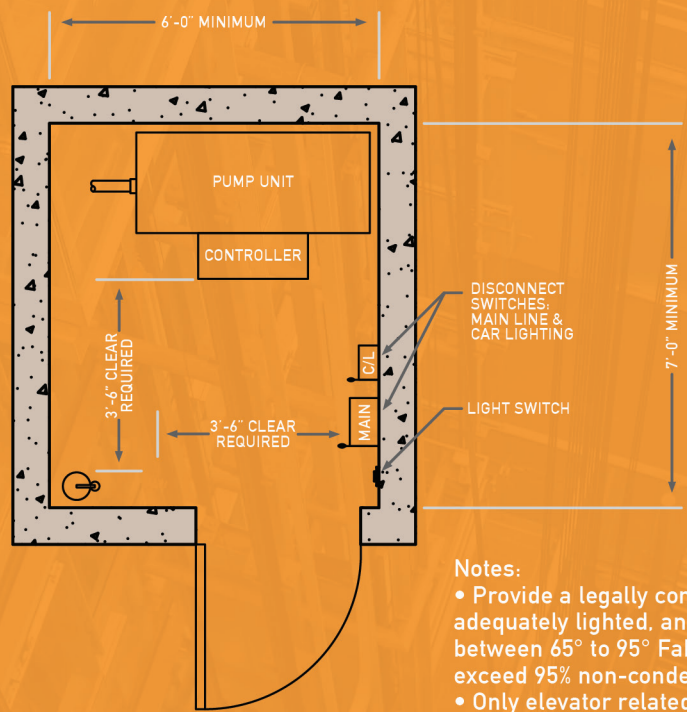

- Notes:
- Provide a legally constructed and enclosed machine room, adequately lighted, and conditioned to maintain temperature between 65° to 95° Fahrenheit, relative humidity is not to exceed 95% non-condensing
 - Only elevator related equipment is allowed in machine room

ADA MINIMUM WHEELCHAIR CAR DIMENSIONS

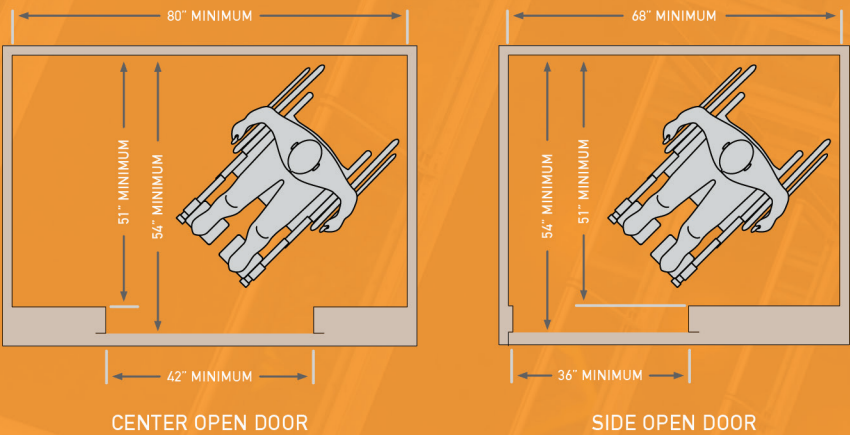

ELECTRIC DATA

HP	VOLT	Full Load Amps	Locked Rotor Amps (Wye-Delta)
15	208	51	82
15	230/460	45/22.5	68/34
20	208	66	104
20	230/460	56/28	90/45
25	208	78	130
25	230/460	68/34	113/57
30	208	90	157
30	230/460	78/39	136/68
40	208	120	224
40	230/460	104/52	195/97
50	208	142	307
50	230/460	123/62	268/113

Electrical Data for Hydraulic 3 Phase Motors (80 Starts Per Hour) in a Submersible Power Unit